

■ 一般角の三角関数

氏名 _____

$\bullet \sin A = \frac{\text{縦}}{\text{斜め}}$
 $\bullet \cos A = \frac{\text{横}}{\text{斜め}}$
 $\bullet \tan A = \frac{\text{縦}}{\text{横}}$

(復習) 次の直角三角形を用いて, $30^\circ, 45^\circ, 60^\circ, 120^\circ, 135^\circ, 150^\circ$ の \sin, \cos, \tan の値を求めなさい。

$\sin 30^\circ = \square$

$\cos 30^\circ = \square$

$\tan 30^\circ = \square$

$\sin 45^\circ = \square$

$\cos 45^\circ = \square$

$\tan 45^\circ = \square$

$\sin 60^\circ = \square$

$\cos 60^\circ = \square$

$\tan 60^\circ = \square$

■ 120° の三角比

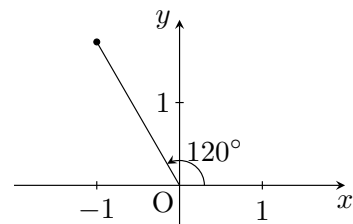

$\sin 120^\circ = \square$
 $\cos 120^\circ = \square$
 $\tan 120^\circ = \square$

■ 135° の三角比

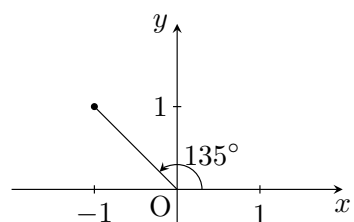

$\sin 135^\circ = \square$
 $\cos 135^\circ = \square$
 $\tan 135^\circ = \square$

■ 150° の三角比

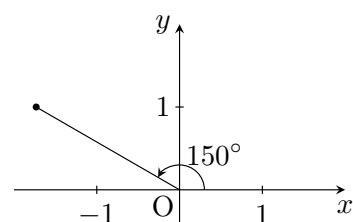

$\sin 150^\circ = \square$
 $\cos 150^\circ = \square$
 $\tan 150^\circ = \square$

■ 210° の三角比

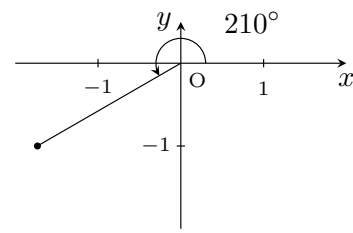

$\sin 210^\circ = \square$
 $\cos 210^\circ = \square$
 $\tan 210^\circ = \square$

■ 225° の三角比

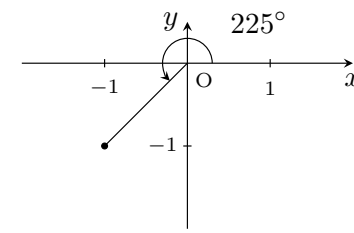

$\sin 225^\circ = \square$
 $\cos 225^\circ = \square$
 $\tan 225^\circ = \square$

■ 240° の三角比

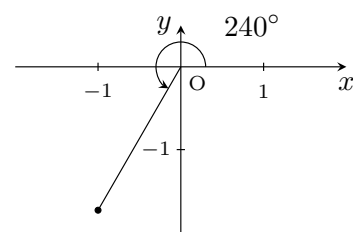

$\sin 240^\circ = \square$
 $\cos 240^\circ = \square$
 $\tan 240^\circ = \square$

■ 300° の三角比

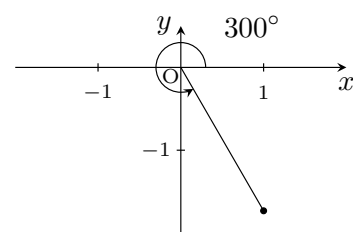

$\sin 300^\circ = \square$
 $\cos 300^\circ = \square$
 $\tan 300^\circ = \square$

■ 315° の三角比

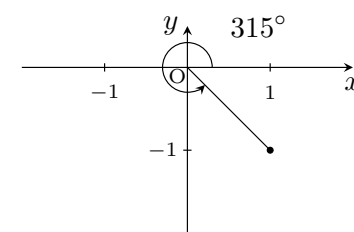

$\sin 315^\circ = \square$
 $\cos 315^\circ = \square$
 $\tan 315^\circ = \square$

■ 330° の三角比

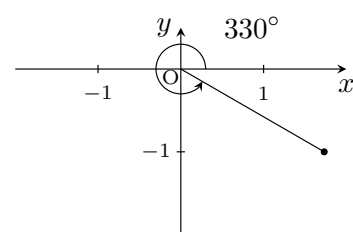

$\sin 330^\circ = \square$
 $\cos 330^\circ = \square$
 $\tan 330^\circ = \square$